

THIS DRAWING IS COPYRIGHT, AND REMAINS THE PROPERTY OF
HTC ARCHITECTS. IT MUST NOT BE REPRODUCED, USED,
DISCLOSED OR TRANSMITTED TO THIRD PARTIES IN ANY FORM, IN
WHOLE OR IN PART, WITHOUT PRIOR WRITTEN PERMISSION.

DO NOT SCALE!
ALL DIMENSIONS SHOULD BE CHECKED ON SITE BEFORE
WORK COMMENCES

BASED ON LIDL BBS 2021 TYPE 1400 SPECIFICATION.
LD(14)-GF-01 GROUND FLOOR - SETTING OUT PLAN. REV. A.
DATED 25.10.21.

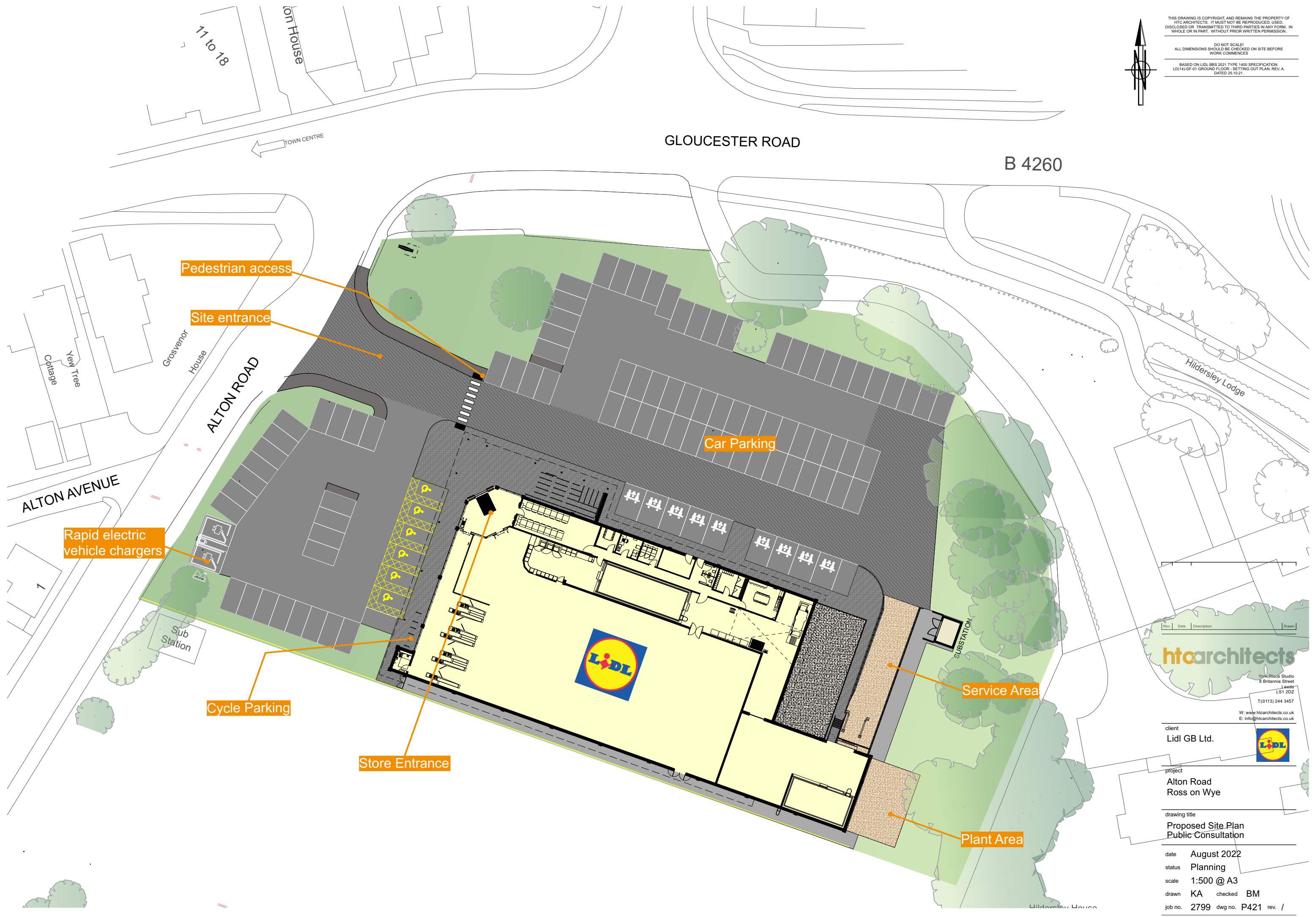

Rev.	Date	Description	Drawn
------	------	-------------	-------

htcarchitects

York Black Studio
8 Britannia Street
Leeds
LS1 2DZ
T: (0113) 244 3457
W: www.htcarchitects.co.uk
E: info@htcarchitects.co.uk

client
Lidl GB Ltd.



project
**Alton Road
Ross on Wye**

drawing title
**Proposed Site Plan
Public Consultation**

date **August 2022**
status **Planning**
scale **1:500 @ A3**
drawn **KA** checked **BM**
job no. **2799** dwg no. **P421** rev. **/**